

5TH FLOOR PLAN
FURNITURE LAYOUT PLAN

PROJECT:
**PROPOSED PLAN OF ADMINISTRATIVE OFFICE STATE BANK OF INDIA
URBAN ESTATE-PHASE-II AT BATHINDA**

DATE:	28.08.2023
SCALE:	N-T-S
DWG No.	DIC/SBI/37AO/5TH/FUR/01

design innovations
ARCHITECTS, INTERIOR DESIGNERS, PLANNERS
#445, URBAN ESTATE, PHASE II, BATHINDA
PH: 2212131 (O) 98154-81651 (M)



REVISED LAYOUT

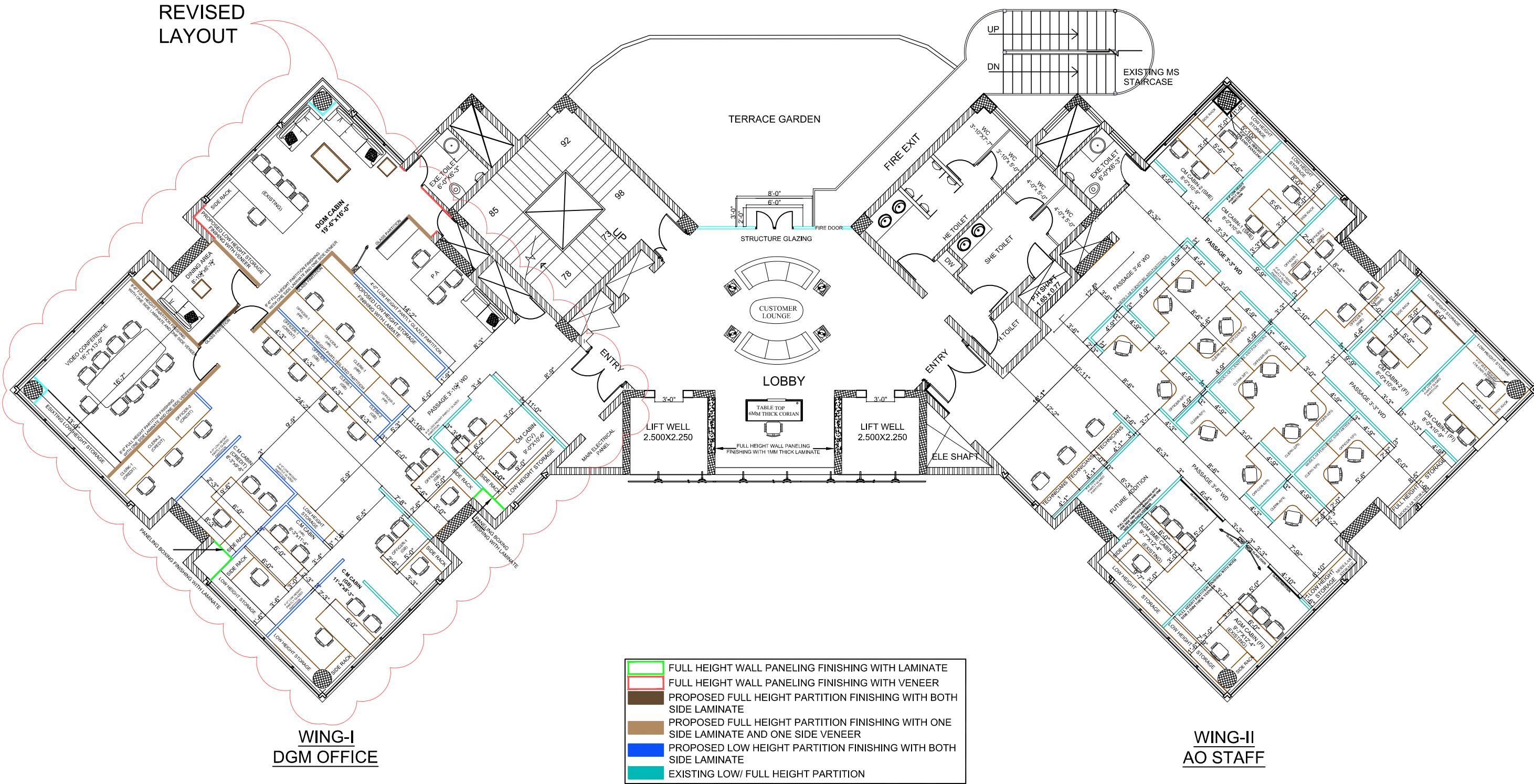

WING-I
DGM OFFICE

WING-II
AO STAFF

- FULL HEIGHT WALL PANELING FINISHING WITH LAMINATE
- FULL HEIGHT WALL PANELING FINISHING WITH VENEER
- PROPOSED FULL HEIGHT PARTITION FINISHING WITH BOTH SIDE LAMINATE
- PROPOSED FULL HEIGHT PARTITION FINISHING WITH ONE SIDE LAMINATE AND ONE SIDE VENEER
- PROPOSED LOW HEIGHT PARTITION FINISHING WITH BOTH SIDE LAMINATE
- EXISTING LOW/ FULL HEIGHT PARTITION

4TH FLOOR PLAN
REVISED FURNITURE LAYOUT PLAN

PROJECT:
**PROPOSED PLAN OF ADMINISTRATIVE OFFICE STATE BANK OF INDIA
URBAN ESTATE-PHASE-II AT BATHINDA**

DATE: 28.08.2023
SCALE: N-T-S
DWG No. DIC/SBI/37AO/4TH/FUR/R-02

design innovations
ARCHITECTS, INTERIOR DESIGNERS, PLANNERS
#445, URBAN ESTATE, PHASE II, BATHINDA
PH: 2212131 (O) 98154-81651 (M)

